

INSTRUCTIONS

1 First, confirm that model number, the figures "8 TIMES 88.8%" and several other marks appear when the "POWER" button is pressed with your finger. Should the figures not appear, or mark appear, the batteries are exhausted. Replace all of the batteries with new ones, according to the diagram illustrated in the battery chamber.

2 Press the "SELECT" button and repeat until the Selection Indicator and the abbreviation for name of the product you wish to test appears.

3 Take one spoonful of the grain to be measured, and place it evenly in one layer in the Sampling Tray.

NOTE: Put the sample tray to a position where the guide line is hidden.

NOTE: Sort out unripe or degenerated grains from the tray in order to avoid error.

4 Rotate the Crushing Handle counterclockwise, and fully insert the Sampling Tray into the Testing Chamber. **Fully rotate the Crushing Handle until stop is reached**, so that the sample may be well crushed. Press the "MEA." button, the most reliable moisture content is then displayed to be read directly without using any conversion tables.

5 The following indicators each have important meanings. The illuminator lights for 2 seconds when the "POWER" button is pressed and for 4 seconds when the moisture content is displayed or the "SELECT" button is pressed. The Battery Indicator indicates the battery power remaining. This indicator is displayed for approximately 2 seconds when the "POWER" button is pressed.

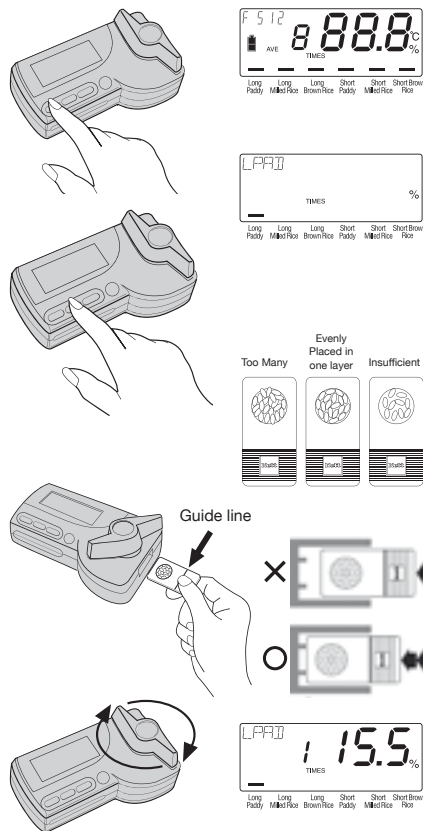

Battery Indicator

Full
Half
Empty

Over Indicator

Under Indicator

Selection Indicator

The Over Indicator " " is displayed when the moisture content of the measured sample exceeds the upper limit of the measurement range, or in the event of problems with the measurement operation, or if irregularities are detected. The Under Indicator " " is displayed when the moisture content of the sample is below the lower limit of the measurement range.

NOTE: Over or under indicators may also be displayed in the event that the measurement procedure is performed without a sample loaded on the sampling tray, there is condensation within the testing chamber, or insulation is poor due to high humidity or soiling. If this should occur, thoroughly clean the testing chamber and allow it to dry through natural evaporation if damp.

6 The averaged moisture content of 2-9 sequential tests is indicated when the "AVE" button is pressed within 2 minutes after the tests. In this case, " " or " " marked tests are disregarded. Numbers of tests being performed is shown on the left part of the digital display. But in the following cases, the reading of the number of tests goes back to "1".

1. **More than 2 minutes have passed after the tests.**
2. **After the tests are already averaged.**
3. **More than 9 tests are performed.**

POWER OFF

1. Press the "POWER" button, the unit will power off.
2. When inactive, the unit will automatically power off after 5 minutes.

After each measurement, clean the Testing Chamber, Crushing Handle and Sampling Tray with the supplied brush.

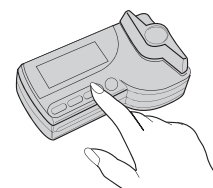
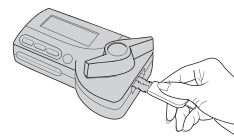

Instruction Manual

Rice Moisture Tester

Riceter f series

Backed by Kett's advanced technology and 50 year experience as a manufacturer specializing in many types of moisture measuring testers for various purposes, the Riceter Model f always enables the user to accurately measure the moisture content of 3 from 6 types of rice without using any conversion tables. The Model f requires the user only to insert the sampling tray and turn the handle until it stops. All other procedures are automatically conducted with built-in micro-processed temperature compensator and sensitivity adjuster.

Specifications

- Measuring Principle : Electric Resistance
Indication : Digital display
Applications & Measuring Ranges : Refer to *Riceter f series Application Table*
Measuring Accuracy : S.E.C : 0.5% (9 ~ 20%)
(Standard Error of Calibration)
Temperature Compensation : Dual automatic
Battery : 4 pcs x 1.5V ("AA" size)
Dimensions : 164(W) x 94(D) x 65(H)
Weight : approx. 443g Net
Accessories : 2 pcs. Sampling Tray / 1 pc. Brush / 1 pc. Spoon with tweezers / 4 pcs. "AA" Battery / Instruction Manual / 1 pc. Rice Husker (optional) / Carrying Case

Main Body

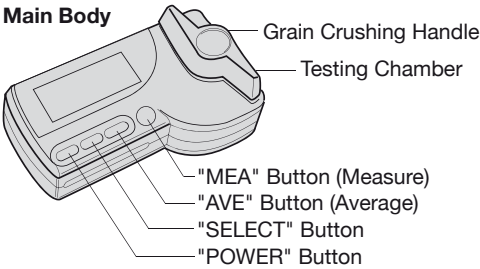

Display

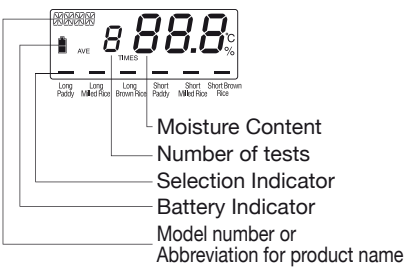

Accessories



Sampling Tray



Brush



Spoon with tweezers

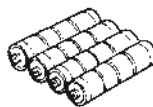

Battery



Carrying Case
Rice Husker (optional)

851090

KETT ELECTRIC LABORATORY

